

**GRAND PENTHOUSE**

LEVEL 18  
 4 BEDROOMS, DEN, FAMILY, LIBRARY, MEDIA ROOM,  
 4 1/2 BATH-ROOMS

|                   |           |
|-------------------|-----------|
| RESIDENCE DATA:   |           |
| CONDITIONED AREA  | 8,111 SF  |
| TERRACE AREA      | 2,085 SF  |
| TOTAL LIVING AREA | 10,196 SF |

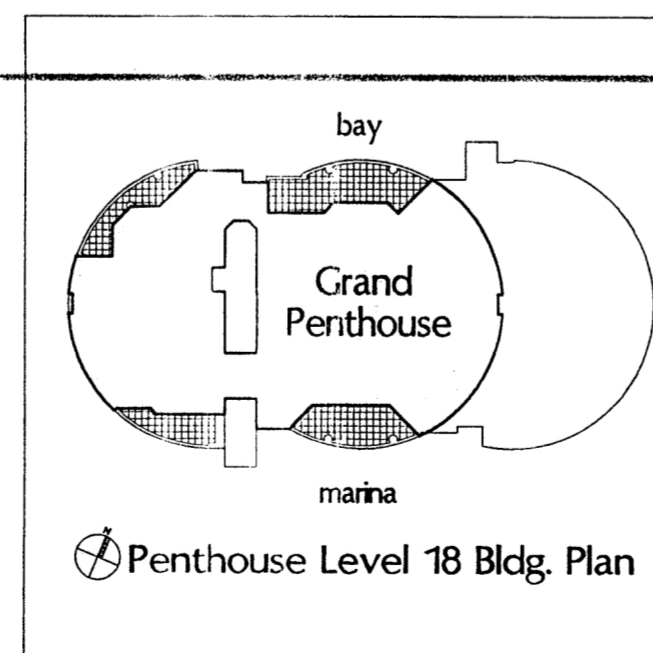

All dimensions are approximate. This floor plan is subject to change without notice. The seller reserves the absolute right, in its sole judgment and discretion, to substitute appliances, materials, fixtures and equipment of equal or greater quality or value for those specified. Oral representations cannot be relied upon as correctly stating representations of the developer. For correct representations, make reference to this brochure and to the documents required by section 78.503, Florida statutes, to be furnished by a developer to a buyer.